

其余 

Technical drawing of a mechanical part (Figure 10-10) showing a cross-section with various dimensions and tolerances. The part has a total height of 100 and a total width of 119. Key features include a 90-degree fillet with R1, a 45-degree fillet with R2, and a 1.6x45 degree chamfer. Surface textures are indicated by symbols like 0.1 A, 0.05 B, and 0.05 A. Dimensions are given in millimeters, with some values in parentheses representing theoretical or nominal dimensions.

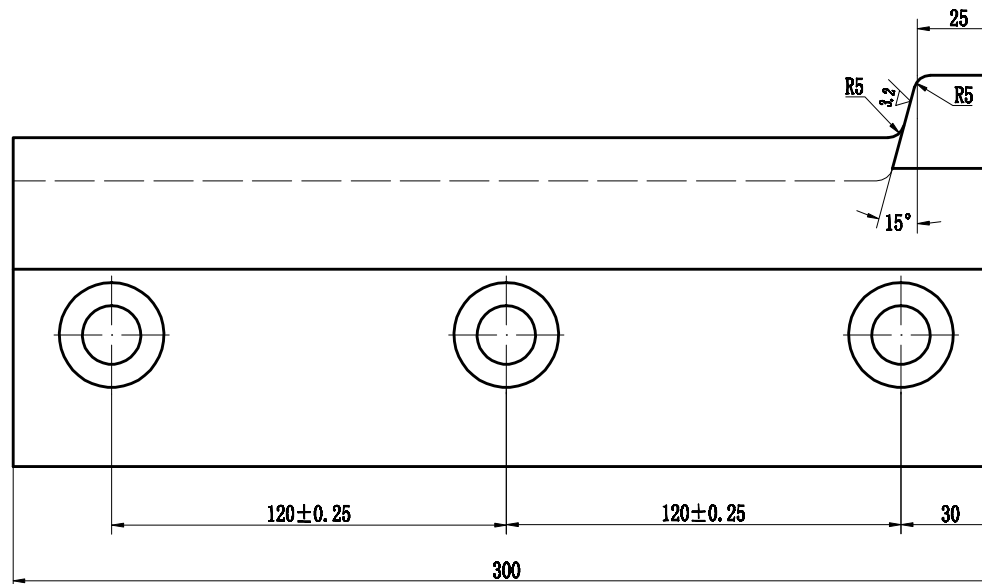
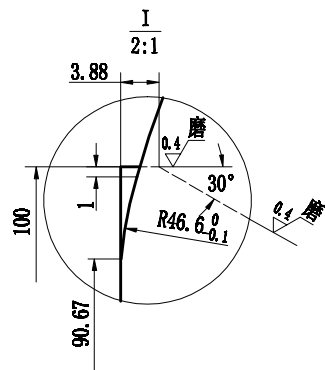

						材料	H13	安徽天一重工股份有限公司
						Z383056.00/02.12.01		飞剪剪刀
标记	处数	更改文件号	签字	日期		图 样 标 记	重 量	比 例
设 计			标准化				5.5	1:1.5
绘 图			批 准					
审 核			校 对					
工 艺			日 期			共 张	第 张	JY300x119x26.6-03